



Exchange
for good

— MADE IN ITALY —

NUOVA DN100 / NEW DN100



TAILOR MADE
HEAT EXCHANGERS
CIPRIANI

GAMMA PRODOTTI / PRODUCT RANGE DN 100

Standard o Personalizzabili
Standard or Customized



Exchange
for good

NUOVE PIASTRE NEW PLATES

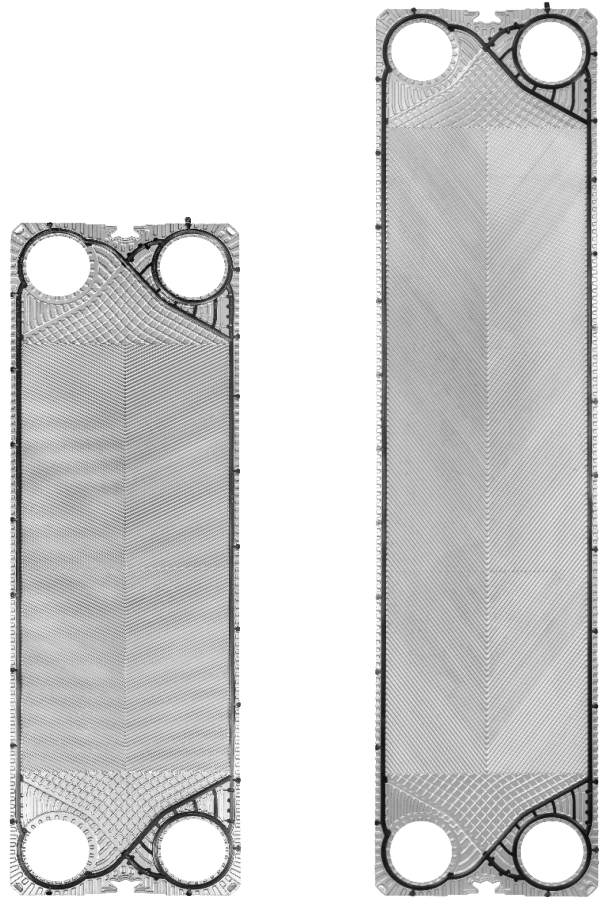

Gamma Prodotti	Product Range	P455+			P705+		
Area di scambio [m ²]	Exchange area [m ²]	0,47			0,688		
Larghezza [mm]	Width [mm]	427					
Altezza [mm]	Height [mm]	1325			1770		
Diametro attacchi	Connections diameter	DN100 4"					
Capacità canale [l]	Channel capacity [l]	1,033			1,413		
Quota di serraggio [mm] *	Tightening quote [mm] *	2,7					
Peso piastra (con guarnizione) [Kg] *	Plate weight (with gasket) [Kg] *	2,074			2,832		
Angolo di corrugazione	Corrugation angle	A/B					
Portata max d'acqua [m ³ /h]	Max. water flowrate [m ³ /h]	240					
PS=> Pressione max di esercizio [bar]	PS=> Max working pressure [bar]	10	16	25	10	16	25

* standard AISI316L 0,5mm

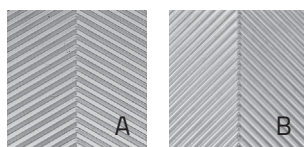

Piastre disponibili in due lunghezze termiche (A/B)

Plates are available in two thermal lengths (A/B)

DN32	DN50	DN65	DN80	DN100	DN150	DN200
------	------	------	------	-------	-------	-------

Tutti i dati e disegni nel presente documento possono subire variazioni senza preavviso e non sono vincolanti per il produttore.
All data and drawings herewith described can be changed without prior notice and are not binding for the manufacturer.



Exchange
for good

TAILOR MADE
HEAT EXCHANGERS
CIPRIANI

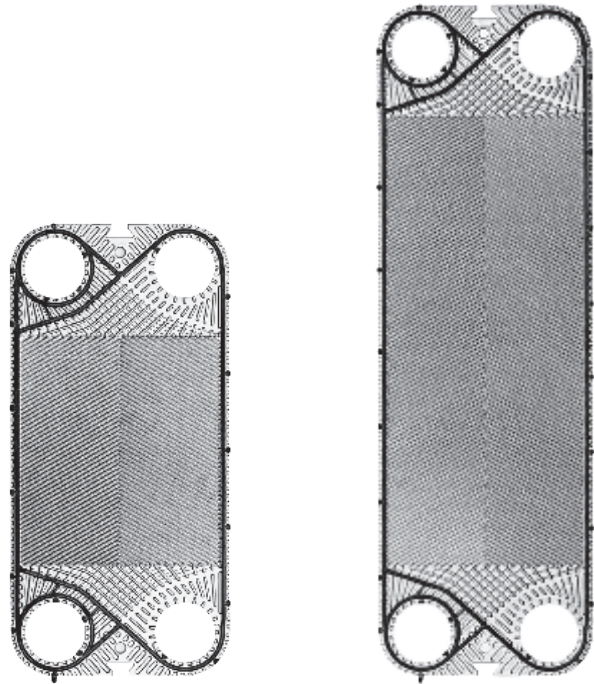

Gamma Prodotti	Product Range	P300+			P450+		
Area di scambio [m ²]	Exchange area [m ²]	0,268			0,482		
Larghezza [mm]	Width [mm]	425					
Altezza [mm]	Height [mm]	877			1322		
Diametro attacchi	Connections diameter	DN100 4"					
Capacità canale [l]	Channel capacity [l]	0,766			1,217		
Quota di serraggio [mm] *	Tightening quote [mm] *	3,1					
Peso piastra (con guarnizione) [Kg] *	Plate weight (with gasket) [Kg] *	1,417			2,207		
Angolo di corrugazione	Corrugation angle	A/B					
Portata max d'acqua [m ³ /h]	Max. water flowrate [m ³ /h]	240					
PS=> Pressione max di esercizio [bar]	PS=> Max working pressure [bar]	10	16	25	10	16	25

* standard AISI316L 0,5mm

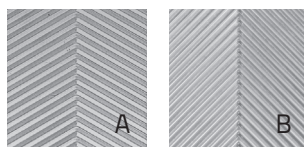

Piastre disponibili in due lunghezze termiche (A/B)

Plates are available in two thermal lengths (A/B)

DN32	DN50	DN65	DN80	DN100	DN150	DN200
------	------	------	------	-------	-------	-------

Tutti i dati e disegni nel presente documento possono subire variazioni senza preavviso e non sono vincolanti per il produttore.
All data and drawings herewith described can be changed without prior notice and are not binding for the manufacturer.

DIMENSIONI TELAI / FRAMES DIMENSIONS - S450+ / S455+ / S705+

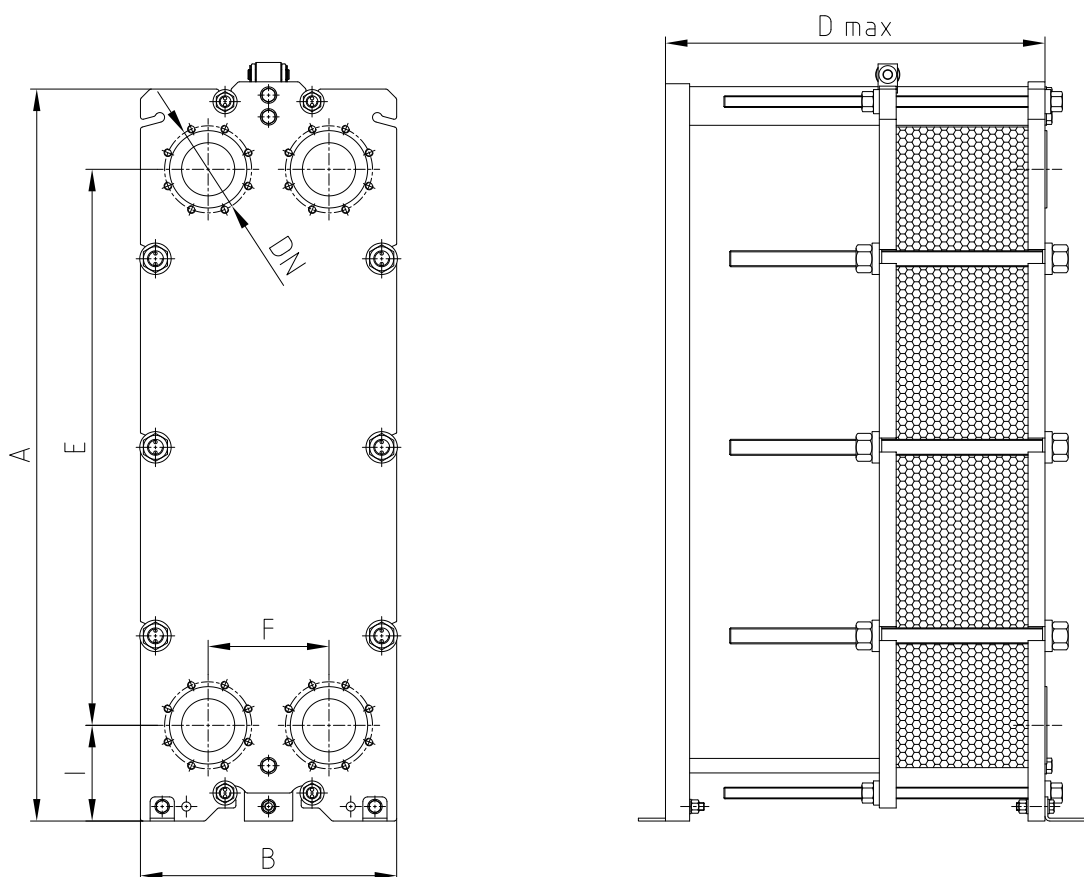

	S450+				S455+				S705+			
A	1569				1569				2034			
B	530				530				530			
E	1150				1150				1595			
F	250				250				250			
I	198				198				198			
Np max	101	201	301	401	101	201	301	401	101	201	301	401
D max	800	1300	1800	2300	800	1300	1800	2300	800	1300	1800	2300
DN	DN100 4"											

Ingombro delle connessioni (C) - Connections dimensions (C)

A-A B-B U-U	36 / 48	48
C-C E-E V-V	36 / 48	48

Tutte le dimensioni sono in mm - Np = numero di piastre. All dimensions are in mm - Np = number of plates.

DIMENSIONI TELAI / FRAMES DIMENSIONS - S300+

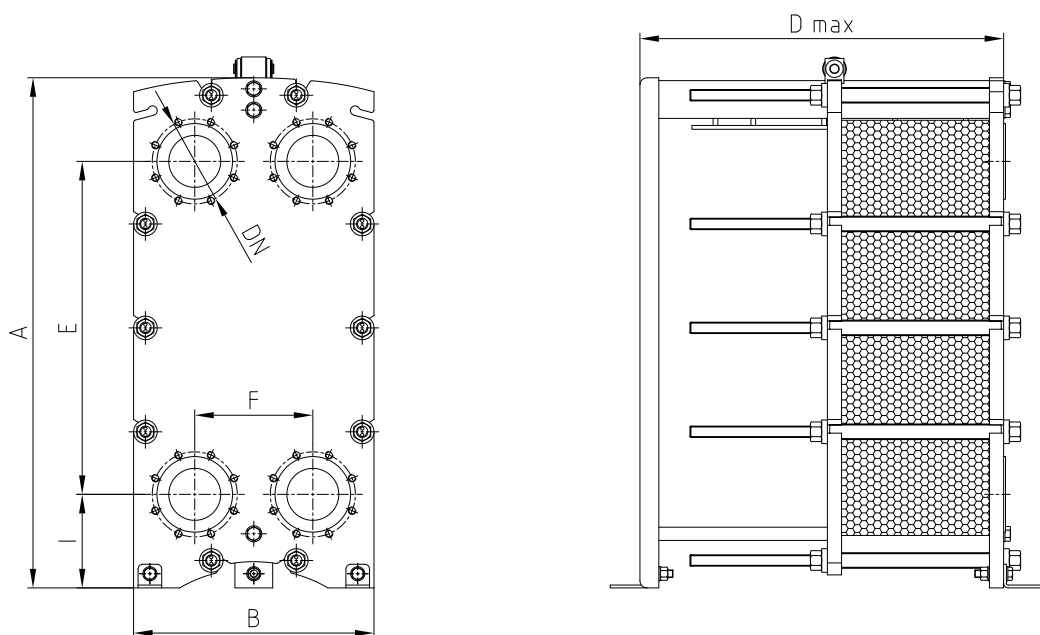

	S300+			
A	1124			
B	509 / 530			
E	705			
F	250			
I	198			
Np max	101	201	301	401
D max	790	1290	1790	2290
DN	DN100 4"			

Ingombro delle connessioni (C) - Connections dimensions (C)		
A-A B-B U-U	36 / 48	48
C-C E-E V-V	36 / 48	48

Tutte le dimensioni sono in mm - Np = numero di piastre. All dimensions are in mm - Np = number of plates.

CONNESSIONI FLANGIATE ISO
ISO STUDED PORTS

A/B/U

CONNESSIONI FLANGIATE ANSI
ANSI STUDED PORTS

C/E/V

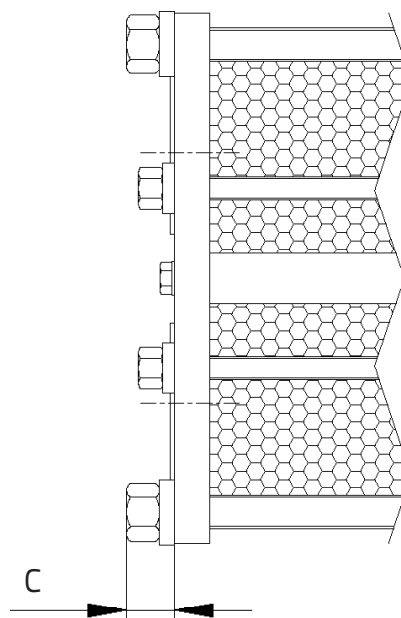

PIEDINI / FEET



	PS10	PS16	PS25
S300+			
Max 101p	853	863	873
Max 201p	1353	1363	1373
Max 301p	1858	1863	1873
Max 401p	2358	2363	2373
S450+ / S455+ / S705+			
Max 101p	861	866	876
Max 201p	1361	1366	1376
Max 301p	1861	1866	1876
Max 401p	2361	2366	2376

Tutte le dimensioni sono in mm. All dimensions are in mm.

		S300+	S450+	S455+	S705+
Piastre Plates	AISI 304	●	●	●	●
	AISI 316L	●	●	●	●
	254 SMO	●	●		
	Titanio / Titanium	●	●		
Guarnizioni Gaskets	NBR	●	●	●	●
	EPDM Prx.	●	●	●	●
	FPM	●	●		
	HNBR	●	●		
Telai Frames **	Acciaio Carbonio / Carbon steel	●	●	●	●
	Acciaio inox / Stainless steel	●	●		
Attacchi Connections**	A / C (Rubber lined)	●	●	●	●
	B / E (AISI316L lined)	●	●	●	●
	U / V (Unlined)	●	●	●	●

Materiali guarnizioni e temperature massime
Gaskets material maximum temperatures

NBR	-20 °C	110 °C
EPDM Prx.	-20 °C	160 °C
FPM	-20 °C	200 °C
HNBR	-20 °C	160 °C

* Le temperature devono essere considerate non applicabili in tutte le condizioni di lavoro.

* The temperatures must be considered not applicable in all working conditions.

** Per configurazioni non standard contattateci. For non-standard configurations please contact us.



Valori **su misura** per voi.
Values **made** for you.

Competenze globali
Global expertise

Flessibilità
Flexibility

Team dedicato
Dedicated team

Standard qualitativi
Quality Standards



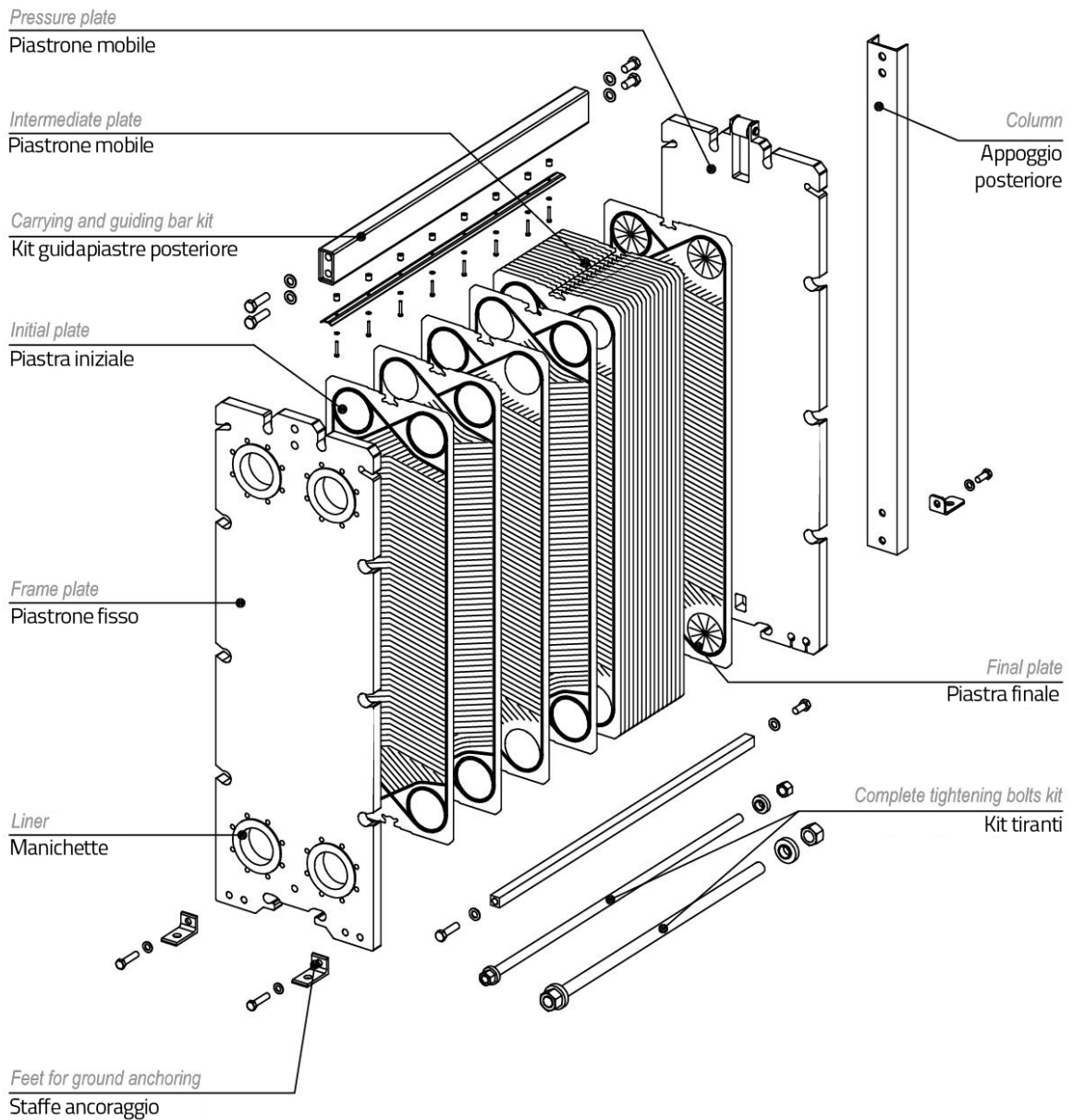

CERTIFICATIONS APPROVALS

ISO 9001

BUREAU VERITAS
Certification



- ISO EN 9001:2015
European Quality Certificates



- PED 2014/68/UE
Pressure Equipment Directive
Module B, D1 & D (up to Risk Cat. IV)



- ACS
Attestation de Conformité Sanitaire



- WRAS
EPDMprx gasket compound approved



- ISO 45001
Occupational Health and Safety



- ISO 14001
Environmental Management



Exchange
for good

Via Nassar, 46 - 37026 Pescantina (VR)
Tel. +39 045 6750065 • Fax +39 045 6750118
info@cipriani-phe.com

cipriani-phe.com