

**Exchange
for good**

— MADE IN ITALY —



TAILOR  **MADE**
HEAT EXCHANGERS
CIPRIANI

GAMMA PRODOTTI / PRODUCT RANGE DN 80 - 3"

Standard o Personalizzabili
Standard or Customized



Exchange
for good

TAILOR MADE
HEAT EXCHANGERS
CIPRIANI



Gamma Prodotti		Product Range	P270+		
Area di scambio [m ²]	<i>Exchange area [m²]</i>		0,273		
Larghezza [mm]	<i>Width [mm]</i>		320		
Altezza [mm]	<i>Height [mm]</i>		1071		
Diametro connessioni	<i>Connections diameter</i>		DN80 3"		
Capacità canale [l]	<i>Channel capacity [l]</i>		0,68		
Quota di serraggio [mm]*	<i>Tightening quote [mm]*</i>		3		
Peso piastra (con guarnizione) [Kg]*	<i>Plate weight (with gasket) [Kg]*</i>		1,321		
Angolo di corrugazione	<i>Corrugation angle</i>		A/B		
Portata max d'acqua [m ³ /h]	<i>Max. water flowrate [m³/h]</i>		110		
PS=> Pressione max di esercizio [bar]	<i>PS=> Max working pressure [bar]</i>		10	16	25

* standard AISI316L 0,5mm

DN32	DN50	DN65	DN80	DN100	DN150	DN200
------	------	------	------	-------	-------	-------

Tutti i dati e disegni nel presente documento possono subire variazioni senza preavviso e non sono vincolanti per il produttore.
All data and drawings herewith described can be changed without prior notice and are not binding for the manufacturer.

DIMENSIONI TELAI / FRAMES DIMENSIONS

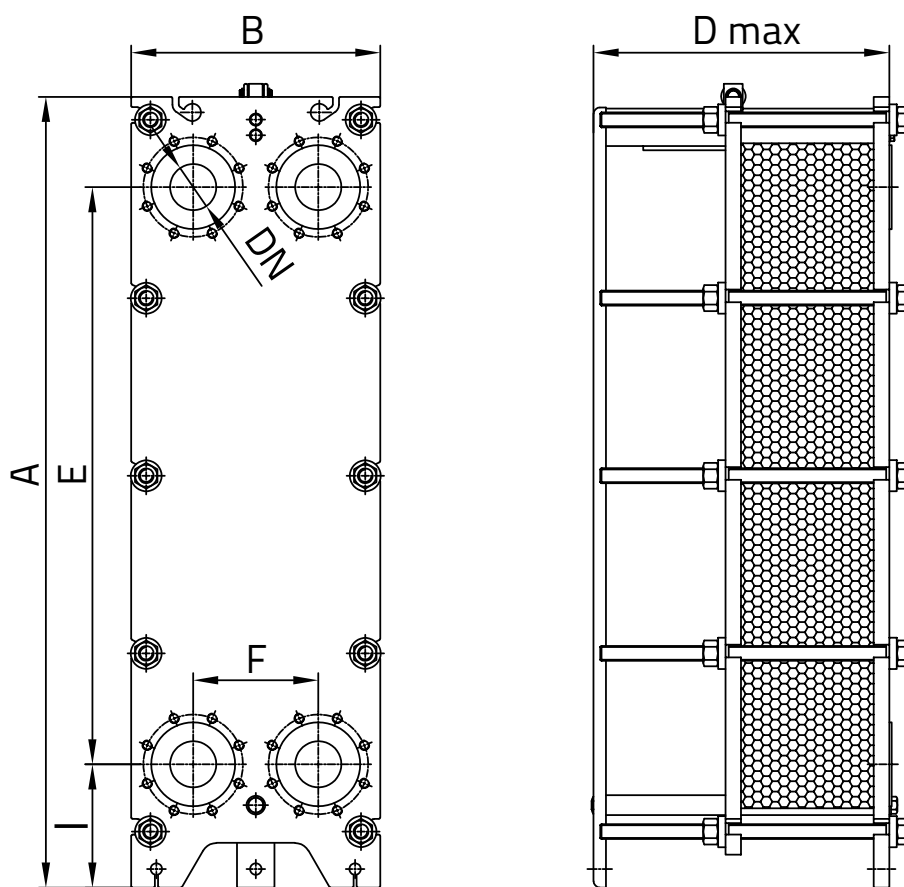

	S270+				
A	1270				
B	400				
E	927				
F	201				
I	198				
Np max	41	71	101	151	251
D max	485	485	625	855	1315
DN	DN80 3"				

Ingombro delle connessioni (C) / Connections dimensions (C)

A-A B-B U-U	36
C-C E-E V-V	36

Tutte le dimensioni sono in mm - Np = numero di piastre. All dimensions are in mm - Np = number of plates.

CONNESSIONI FLANGIATE ISO
ISO STUDDED PORTS

A/B/U

CONNESSIONI FLANGIATE ANSI
ANSI STUDDED PORTS

C/E/V

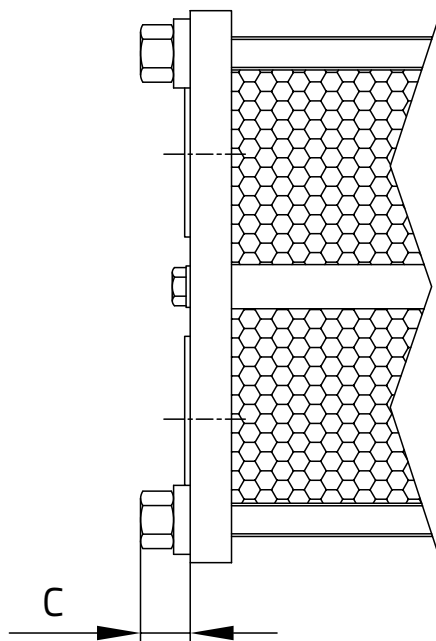

ANCORAGGIO A TERRA (G) / GROUND ANCHORING (G)

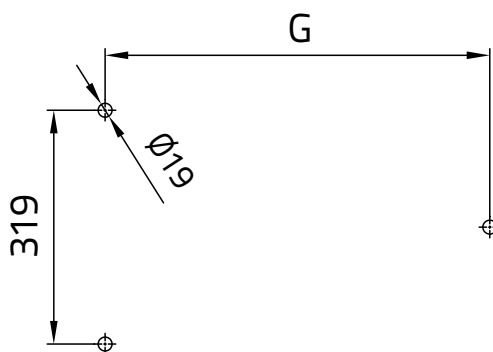

	PS 10	PS 16	PS 25
S270+			
Max 41p	578	583	588
Max 71p	578	583	588
Max 101p	718	723	728
Max 151p	948	953	958
Max 251p	1408	1413	1418

Tutte le dimensioni sono in mm.
All dimensions are in mm.

		S270+
Piastre <i>Plates</i>	AISI 304	●
	AISI 316L	●
	254 SMO	●
	Titanio / <i>Titanium</i>	●
Guarnizioni <i>Gaskets</i>	NBR	●
	EPDM Prx.	●
	FPM	●
	HNBR	●
Telai <i>Frames**</i>	Acciaio Carbonio / <i>Carbon steel</i>	●
	Acciaio inox / <i>Stainless steel</i>	
Attacchi <i>Connections</i> **	A / C (Rubber lined)	●
	B / E (AISI316L lined)	●
	U / V (Unlined)	●

Materiali guarnizioni e temperature massime
Gaskets material maximum temperatures

NBR	-20 °C	110 °C
EPDM Prx.	-20 °C	160 °C
FPM	-20 °C	200 °C
HNBR	-20 °C	160 °C

*Le temperature devono essere considerate non applicabili in tutte le condizioni di lavoro.
The temperatures must be considered not applicable in all working conditions.

** Per configurazioni non standard contattateci.
For non-standard configurations please contact us.

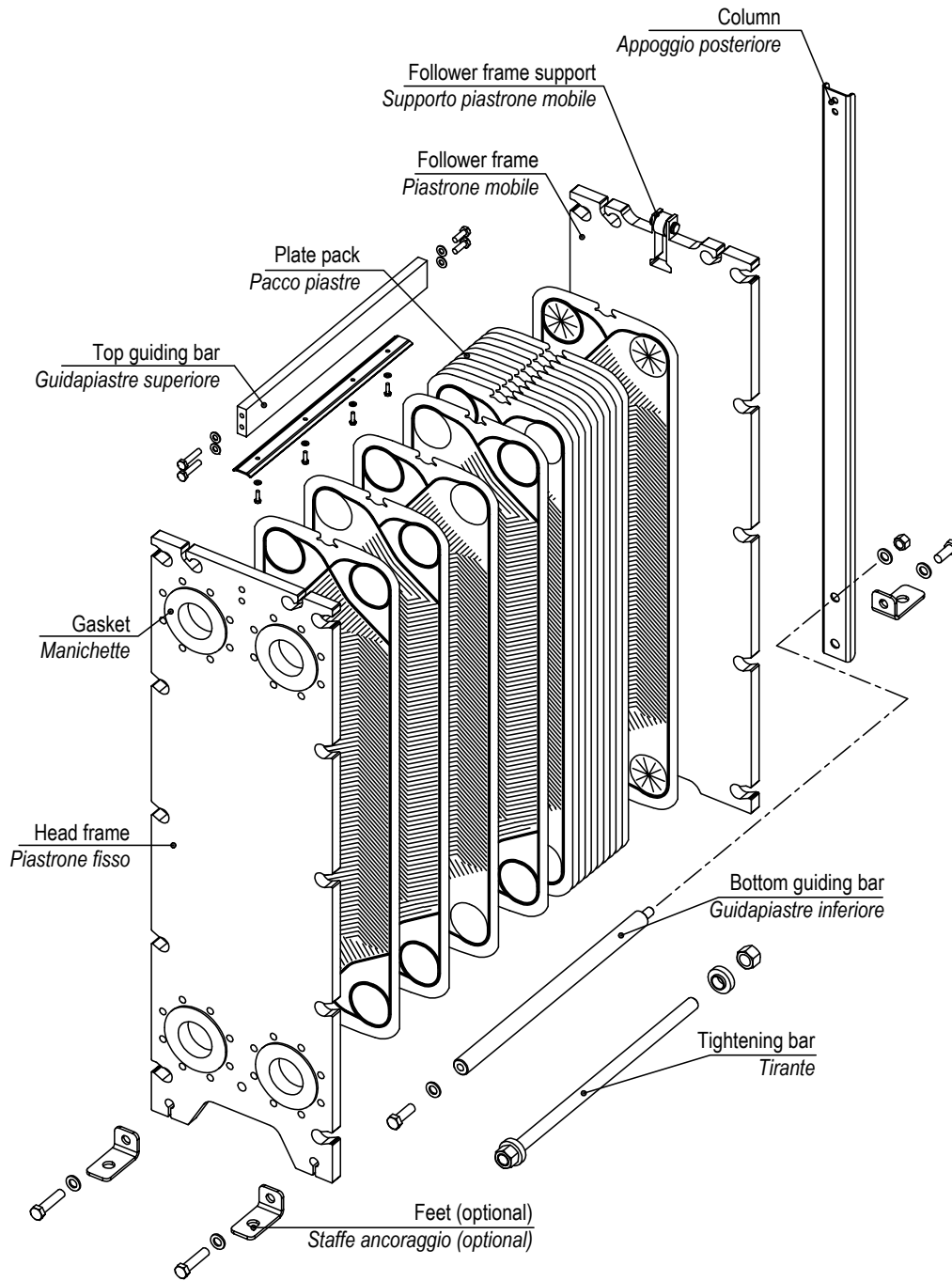

CERTIFICATIONS APPROVALS



▪ ACS
Attestation de Conformité Sanitaire

▪ OHSAS 18001
Occupational Health and Safety

▪ ISO EN 9001:2015
European Quality Certificates

▪ PED 2014/68/UE
Pressure Equipment Directive
Module B,D1 & D (up to Risk Cat. IV)



▪ WRAS
EPDMprx gasket compound approved



▪ ISO 14001
Environmental Management



Exchange
for good

Via Nassar, 46 - 37026 Pescantina (VR)
Tel. +39 045 6750065 • Fax +39 045 6750118
info@cipriani-phe.com
cipriani-phe.com